



Instrument Panel Center Reinforcement (76.46.34)

Removal

All vehicles

1. Remove the floor console. For additional information, refer to [Floor Console \(76.25.01\)](#) (Section 501-12)
2. Remove the audio unit. For additional information, refer to [Audio Unit \(86.50.81\)](#) (Section 415-01)
3. Remove the climate control assembly.
 - ▶ Disconnect the 4 electrical connectors.

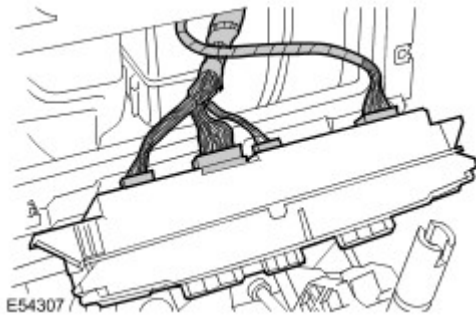

4. Remove the instrument panel switch assembly.
 - ▶ Remove the 2 Torx screws.
 - ▶ Disconnect the electrical connector.

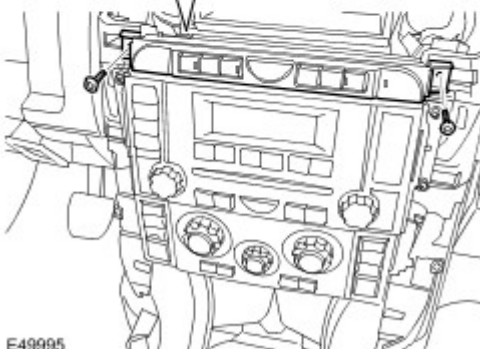
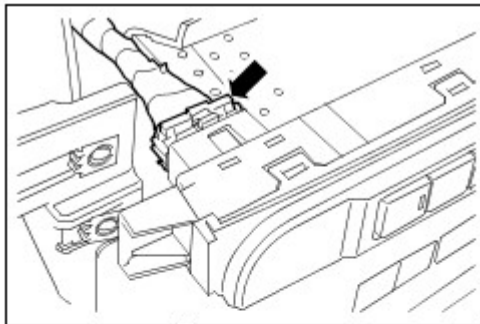

5. Remove the cigar lighter assembly.
- Remove the 2 Torx screws.
 - Release the 3 clips.
 - Disconnect the 3 electrical connectors.

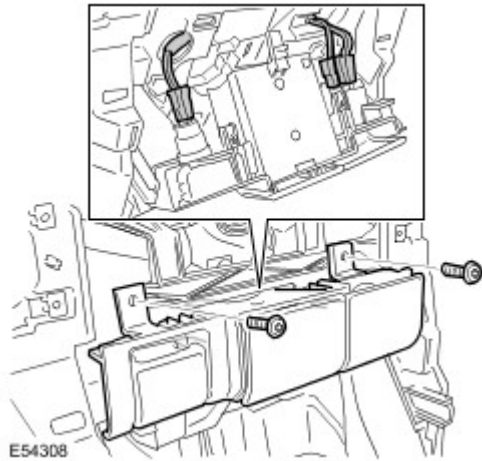

6. Remove the driver side closing trim panel.
- Release the clip.
 - Remove the 2 screws.
 - Disconnect the electrical connector.

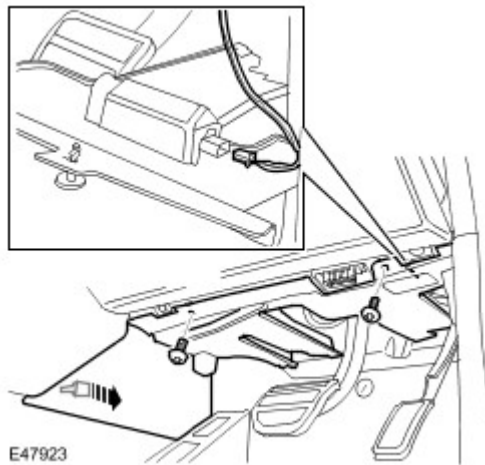

7. Remove the passenger side closing trim panel.
- Release the clip.
 - Remove the 2 screws.
 - Disconnect the electrical connector.

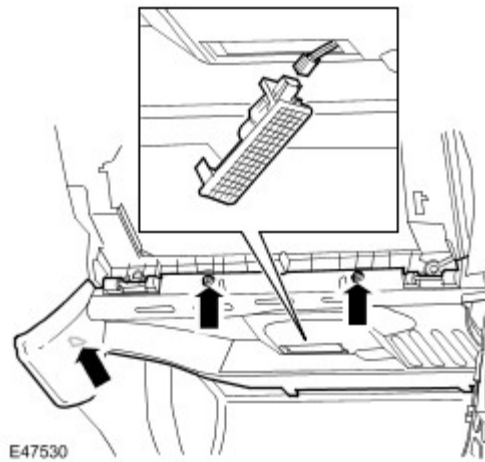

8. Remove the instrument panel center reinforcement 2 side Torx screws.

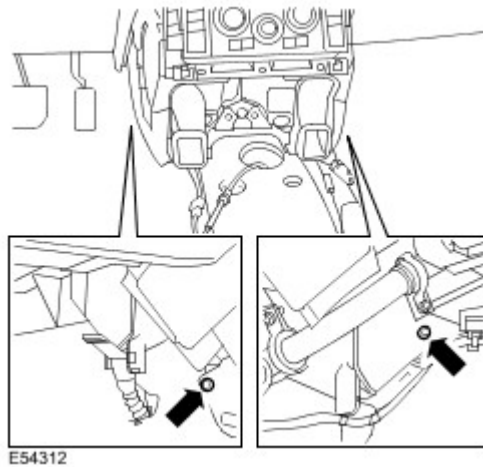

Vehicles with navigation system

1.



CAUTION: Cover fibre optic cable connectors to minimise dust ingress and avoid bending the cables in a radius of less than 30 mm.

Remove the navigation system display module.

- Remove the 4 Torx screws.
- Disconnect the fibre optic connector.
- Disconnect the 2 electrical connectors.

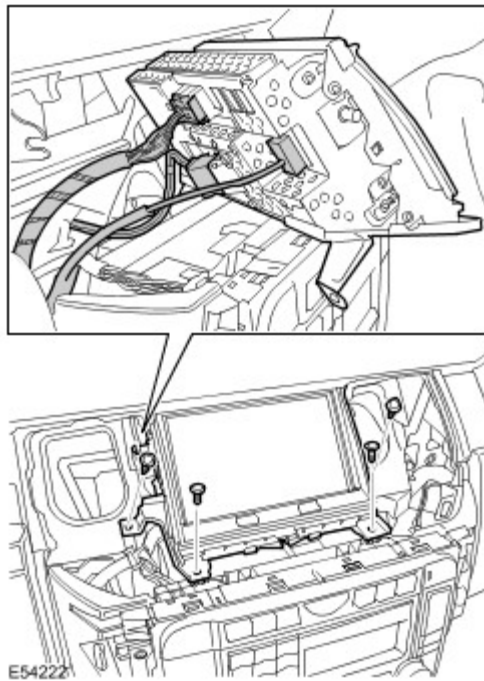

All vehicles

1. Release the heater duct.
▶ Remove the 3 clips.

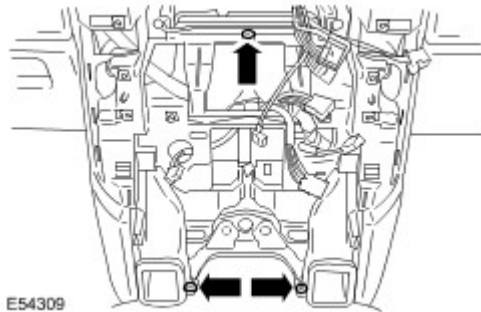

2. Release the LH wiring harness from the instrument panel center reinforcement.
▶ Release the clip.
3. Release the RH wiring harness from the instrument panel center reinforcement.
▶ Release the clip.

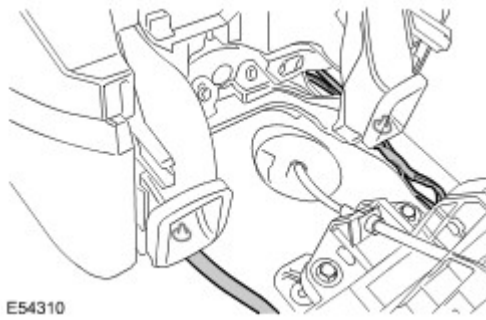

4. Remove the instrument panel center reinforcement.
 - Remove the 8 Torx screws.
 - Release the 4 clips.

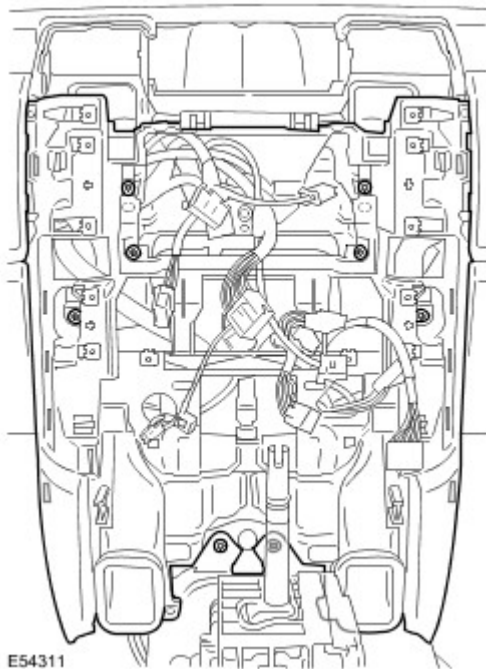

Installation

All vehicles

1. Install the instrument panel center reinforcement.
 - Secure the clips.
 - Tighten the Torx screws.
2. Secure the wiring harnesses.
 - Secure with the clips.
3. Attach the heater duct.
 - Install the clips.

Vehicles with navigation system

- 1 . Install the navigation system display module.
 - Connect the electrical connectors.
 - Connect the fibre optic connector.
 - Tighten the Torx screws.

All vehicles

- 1 . Install the passenger side closing trim panel.
 - Connect the electrical connector.
 - Secure the clip.
 - Tighten the screws.
- 2 . Install the driver side closing trim panel.
 - Connect the electrical connector.
 - Secure the clip.
 - Tighten the screws.
- 3 . Install the cigar lighter assembly.
 - Tighten the screws.
 - Connect the electrical connectors.
 - Secure with the clips.
- 4 . Install the instrument panel switch assembly.
 - Connect the electrical connector.
 - Tighten the Torx screws.
- 5 . Install the climate control assembly.
 - Connect the electrical connectors.
- 6 . Install the audio unit. For additional information, refer to [Audio Unit \(86.50.81\)](#) (Section 415-01)
- 7 . Install the floor console. For additional information, refer to [Floor Console \(76.25.01\)](#) (Section 501-12)